



Quick Start Guide



PICTURES SHOWN ARE FOR ILLUSTRATION PURPOSE ONLY

1

Download FOBO TPMS App onto your smartphone. It is available on both the Google Play Store & the App Store.



FOBO TPMS

2

Ensure that Bluetooth, Location services, and Internet connection are turned on in your smartphone settings.

3

Open the FOBO TPMS App and sign in/sign up using your personal email address, or sign in via Google account.

A screenshot of the FOBO TPMS app's login screen. The screen has a blue header with the word "Login". Below the header is the FOBO TPMS logo. The main text reads "Welcome to FOBO" followed by "Please enter your login credentials." There are two input fields: "Email" with an envelope icon and "Password" with a lock icon and a "show/hide" icon. Below the fields is a black "Login" button. A link for "Forgot Password?" is positioned below the login button. Below this is a horizontal line with the word "Or" in the center. Underneath are two buttons: "Sign in with Google" with the Google logo and "Sign in with Apple" with the Apple logo. At the bottom, there is a link: "Don't have an account? Sign Up".

4

Allow all permissions requested by the App.

5

To install FOB0 TIRE LITE sensor, press the plus (+) button in the middle of the screen.



6

This screen will prompt you to select the product type. Choose "FOBO Tire" and press the "Next" button.

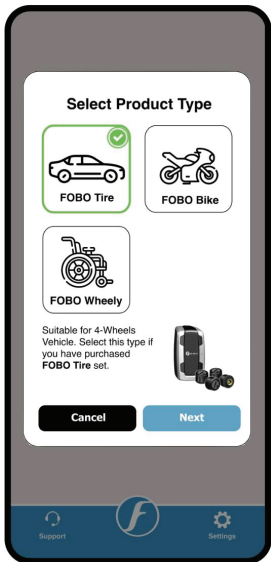

7

On the "Profile Creation" screen, select the installation type. Note that there are two types of FOBO Tire products: one with an In-Car unit and the other without (**FOBO TIRE LITE**).

Select "**FOBO TIRE LITE**" and press the "Next" button.



8

You will be prompted to scan the QR code located to the product box. Scan the QR code, and the app will automatically proceed to the next screen.

However, should you lose the product box (along with the QR code), press the "Skip" button and manually install the 4 sensors one by one.

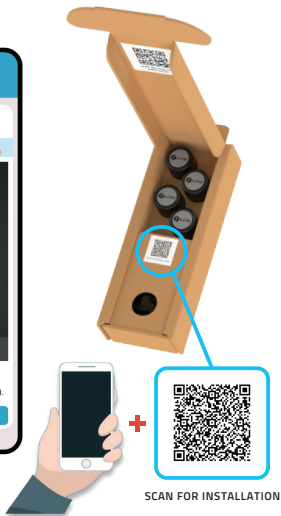
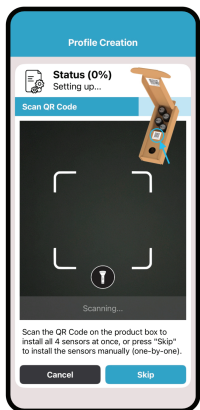

9

Enter a profile name (or vehicle name). Optionally, you can also set a vehicle photo. After entering the profile name, press the "Next" button.

Profile Creation

 **Status (50%)**
Setting up...

Profile Name



Profile Name

Enter your profile name and set your vehicle photo (optional).

Next

10

Enter the recommended tire pressure settings. After setting the pressure, press the "Next" button.

Profile Creation

 **Status (70%)**
Setting up...

Pressure Settings



Tire Position	Min	Rec	Max
Front Tire (FR/FL)	180	200	250
Rear Tire (RR/RL)	180	200	250

Set your vehicle recommended tire pressure or accept the default settings above.

Skip All **Next**

11

Install each sensor on the tire that matches the position shown on its label.

To install a sensor, unscrew sensor cover to remove battery tab. Then, screw the sensor cover back on, ensuring it is tightly secured.

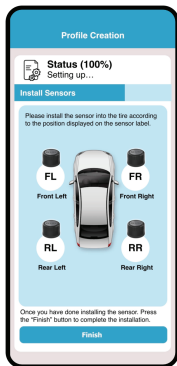
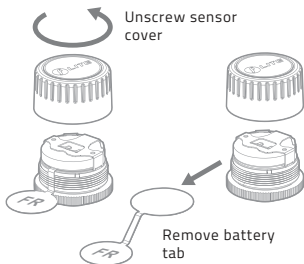

12

Prior to installing sensors on tire valve, install FOBO Lock-Nuts to secure a sensor.

To install FOBO Lock-Nut:

1. Screw on the FOBO Lock-Nut to the tire valve with 'bump' facing inward until the end of the valve thread.
2. Screw on the FOBO TIRE LITE sensor to the tire valve securely.
3. Turn the FOBO Lock-nut counter-clock wise as though you are removing it until it meets the FOBO TIRE LITE sensor.
4. Gently hold the FOBO TIRE LITE sensor and use the provided wrench to further tighten the FOBO Lock-Nut against the FOBO sensor. This is to avoid the twisting of the rubber valve.

Note: Gently tighten the Lock-Nut against the sensor; no excessive force is required.

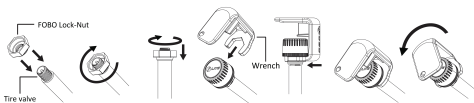

Note: It is recommended to apply some soap water (on the tire valve installed with FOBO sensor) after installing a sensor in order to check for any potential leak.

Once all sensors are installed, press the "Finish" button to complete the setup.

13

Your installation is now complete !
You should now be able to see the sensor readings for each tire on the app's main screen.

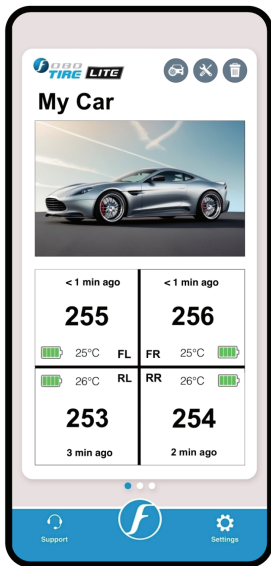



www.my-fobo.com